

INVENTORY

- A. 1 x Door
- B. 2 x Hinges
- C. 8 x Small Screws
- D. 1 x Magnetic Latch Kit

INVENTORY: TOOLS

- E. Phillips Screwdriver

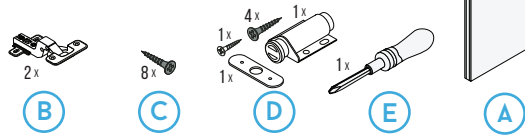

Adjust both hinges at the same time for best effect.

Screw "1" can be loosened by turning counter-clockwise.

The door can then be adjusted front to back to be flush with the outside of the cabinets.

Then, screw "1" should be tightened by turning it clockwise, to maintain the new position.

Screw "2" is used to adjust the gap between the side and the door. If screw "2" is turned counter-clockwise, the door will move closer to the hinges. If screw "2" is moved clockwise, the door will move closer to the magnetic latch.

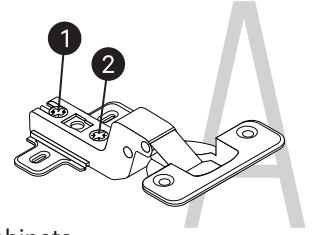

Installing a Door

It's best to install hinges before assembling the cube,

